

# Installation Instructions

for using DesignRail® Rail Cut Kits with DesignRail® Aluminum Rail Kits - LEVEL RAILING

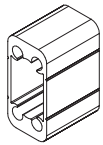

A.

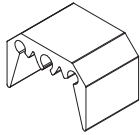

B.

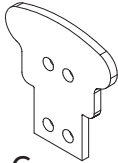

C.

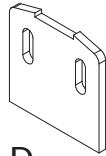

D.

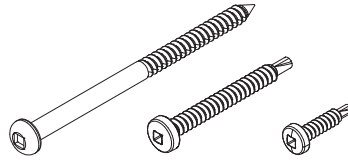

E.

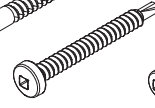

F.



G.

## Parts List:

- A. (2x) Top Rail Connecting Brackets (RCB)
- B. (2x) Bottom Rail Connecting Brackets (RCB)
- C. (2x) Top Rail Isolation Pads
- D. (2x) Bottom Rail Isolation Pads
- E. (8x) #10 x 3" SS Pan Head Screw, Square Drive (RCB to Wood Post)
- F. (8x) #10 x 1-3/4" SS Self-Tapping Pan Head Screws, Square Drive (RCB to Metal Post)
- G. (9x) #8 x 3/4" SS Self-Tapping Pan Head Screws, Square Drive, Colored (Picket to Top Rail and Rails to RCBs)

*Note: DesignRail® Rail Cut Kits are intended to be used with a DesignRail® Rail Kit, when cutting a single rail to be used in two or more separate sections.*

## LEVEL HARDWARE INSTALLATION:

**Important:** Use only to attach DesignRail® Aluminum Rail Kits to wood or metal posts.

### Step 1 - Prepare post for Rail Connecting Brackets (RCBs)

If using pre-drilled DesignRail® Post Kits proceed to Step 2.

For all other posts, mark and pre-drill the posts for the Rail Connecting Bracket (RCB) attachment screws. Each RCB requires 2 screws. The recommended pilot hole for a #10 self-tapping screw (metal post installation) is no less than 5/32" (0.157"). Pilot holes in wood will vary depending on the type of wood. Hardwoods may require larger pilot holes. Refer to the full Level Rail Kit installation instructions for all drill hole locations.

### Step 2 - Attach Rail Connecting Brackets (RCBs) to Posts

Attach the top and bottom isolation pads and Rail Connecting Brackets to each post using the included screws, #10 x 3" wood screws for wood posts and #10 x 1-3/4" self-tapping screws for non-ferrous metal posts. (See Figure 2.1 demonstrating attachment to wood posts).

### Step 3 - Attach Rails to RCBs

Refer to the full Level Rail Kit installation instructions for information on assembling and attaching the rails.

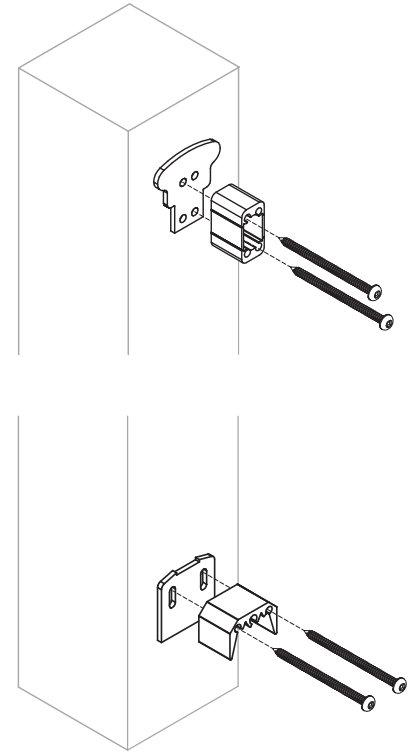

(Figure 2.1)